

ROOM THERMOSTAT KONVEKA MT230



DATASHEET

Product description



MT230 is designed to regulate the room temperature by controlling electric or hydronic underfloor heating devices. The thermostat is controlled by turning the wheel. The LED indicator shows the activity status of the heating system.

Technical specifications

Power supply	AC230V±10%, 50-60Hz
Current load	16A
Temperature setting range	5 - 40°C
Outer-limit temperature	50°C by default
Switching deviation	±0.5°C
Ambient temperature	-5 - 50°C
Protection class	IP20
Housing material	Anti-flammable PC
Length of floor sensor cable	3 m
Dimensions	86 x 86 x 50 mm

Standard set

Thermostat	1 pc.
Floor sensor	1 pc.
Screws	2 pc.
User Guide	1 pc.

Dimensions

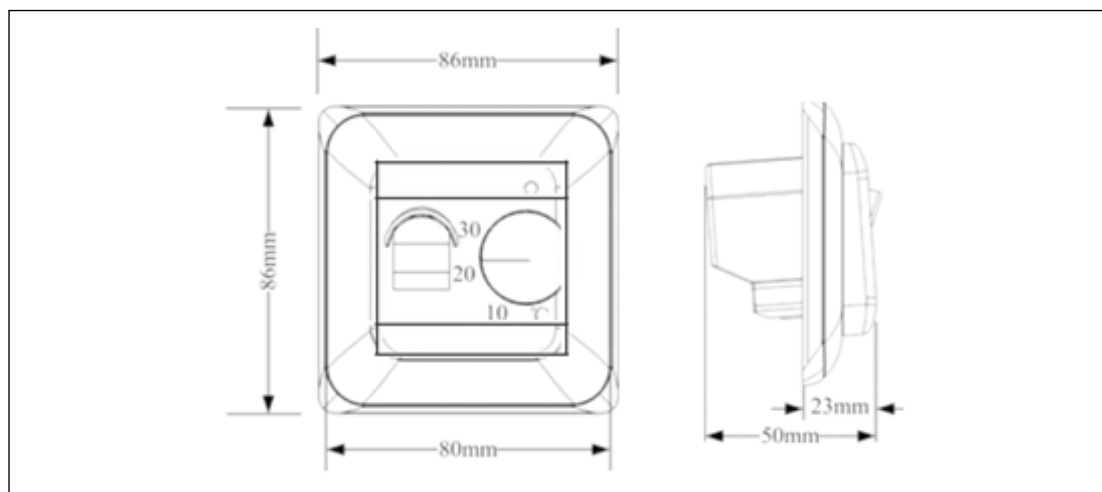

Installation

MT230 is installed in a standard electric installation box. The thermostat must not be exposed to direct sunlight, cannot stand near windows or doors, or on cold walls of the house for accurate operation. Installation height from the floor is 120 – 150 cm.



Installation and maintenance of the thermostat must only be undertaken after disconnecting the power cables! Contact with live power cables could result in serious injury or even death! All installation and maintenance work must be performed by a professional electrician!

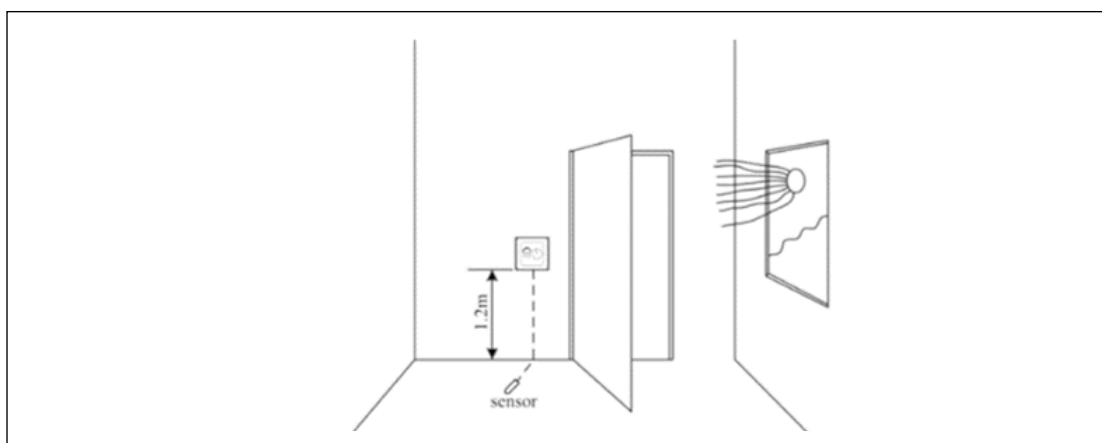

Floor temperature sensor should be placed in installation pipe, which is embedded in floor, the pipe is closed in the end and placed as high as possible in the concrete layer. Sensor cable may be extended up to 50 cm with separate cable.

Mounting steps

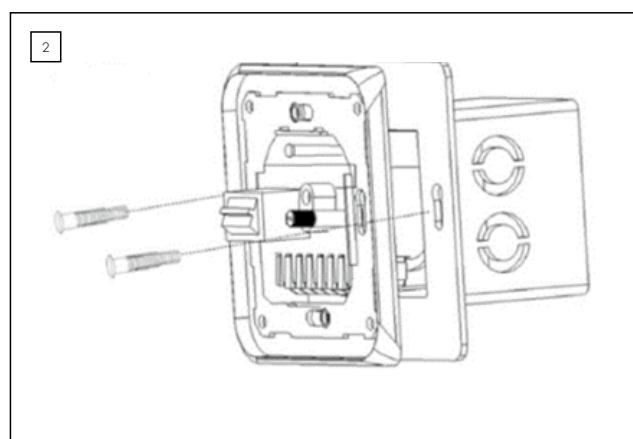
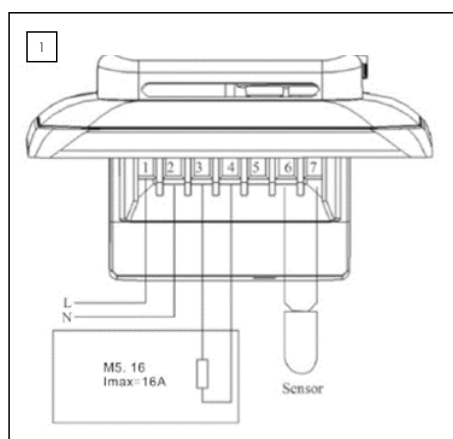

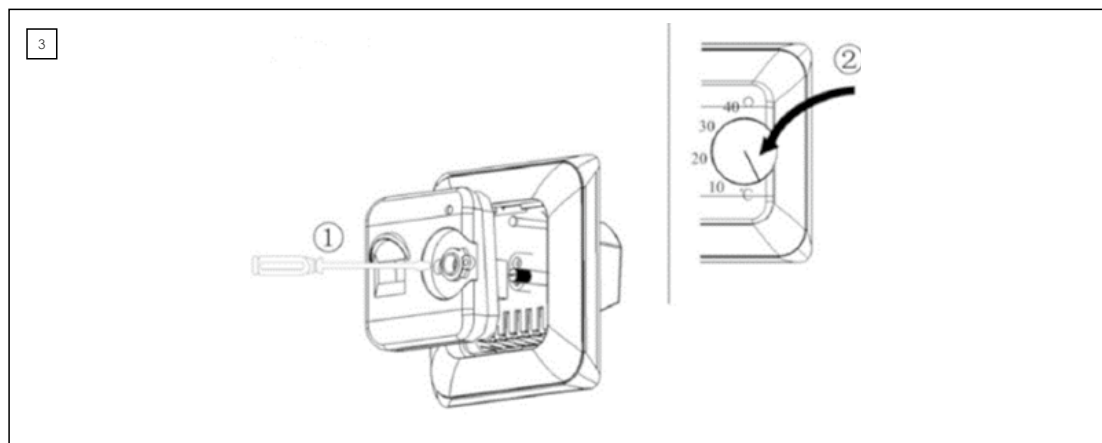

Temperature setting

Thermostat has a scale range of 5 to 40°C. To assist the adjustment, the thermostat has a LED which will glow RED when the heating is ON. Initially, set the thermostat to its maximum temperature setting until the desired room or floor temperature is reached. Then, dial the control knob back until the LED turns off. Fine-tuning can be done over the next day or two to meet individual preferences.

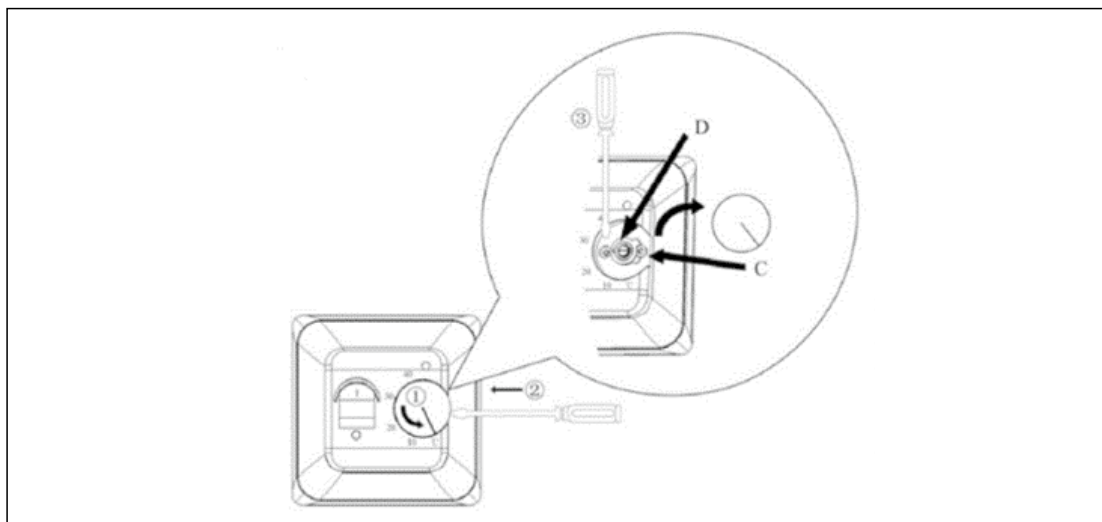

Thermostat adjustment

When the floor temperature has been stabilized, the thermostat set position may be adjusted to match actual floor temperature. Measure the temperature of the floor with an accurate thermometer. Remove control knob (1) and spin the pole (D), then reposition the control knob so that the indicated temperature line shows the same as the measured temperature.

Max/Min temperature setting

A locking mechanism is positioned behind the control knob to limit the amount of adjustment possible. By loosening the small screw C the scale range can be locked, e.g. between 20°C and 25°C. The red ring indicates the maximum temperature, and the green ring indicates the minimum temperature.

Warranty

The thermostat comes with a 24-month warranty. If the thermostat breaks down either during the warranty period or afterwards, or if you have any uncertainties, please contact us:

Telephone number	Email
+370 677 06303	sales@konveka.lt
+370 600 05968	donatas@konveka.lt